

## **+VIA-HS50** Hollow Column



### TECHNICAL DETAILS

<b>Weight</b>	9'970g/m
<b>Material</b>	1.1213 (Cf53)
<b>Surface</b>	Ground, ends cut and chamfered
<b>Treatment</b>	Surface-hardened HRC 59+6

### MODULE DESCRIPTION

Only few elements are required to realize a great variety of structural configurations, by means of these columns made of steel, induction hardened and ground.

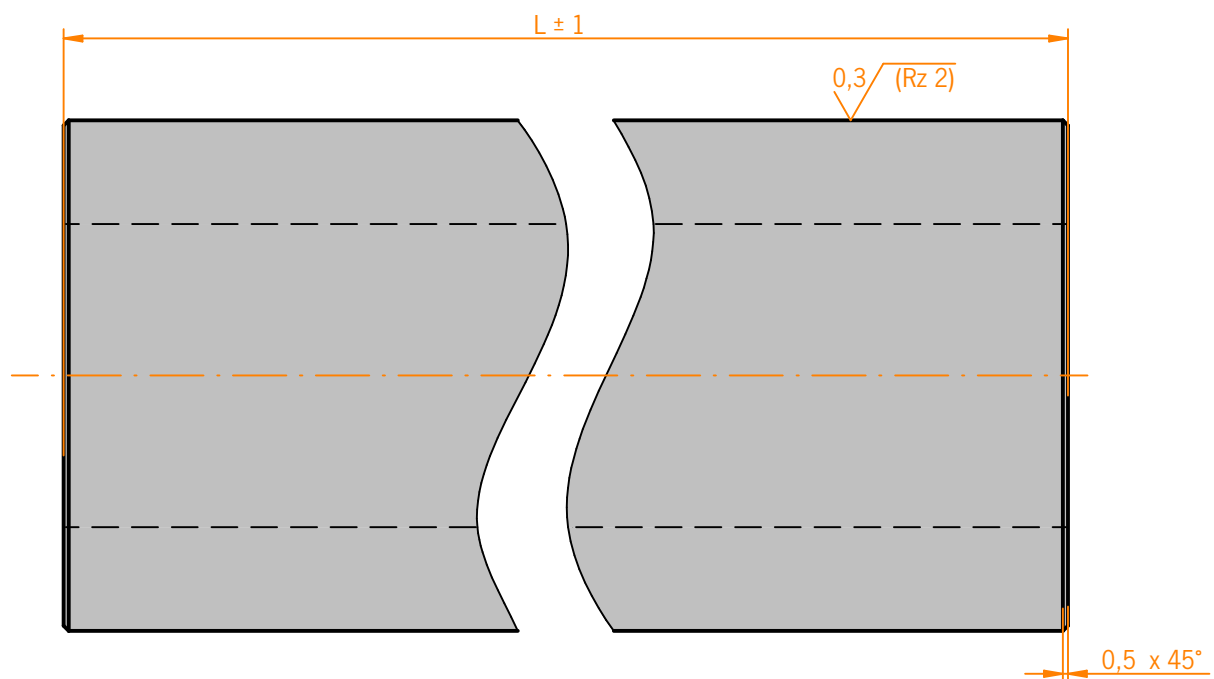
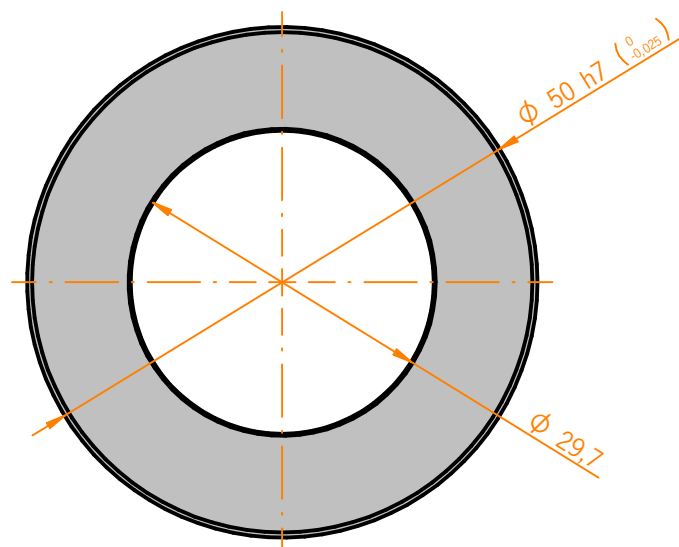

Customized items are available upon request.