

Material Aluminium (milled)

Surface black, red, blue, green, gold, ESD

Positional Tolerance $\pm 0,01$ mm

Fitting Bores

Positional Tolerance $\pm 0,1$ mm

Bores

Module with fitting and mounting bores for precise attachment of components in position. The two-piece structure enables the element quickly to be mounted to a two-column system also at a later date.

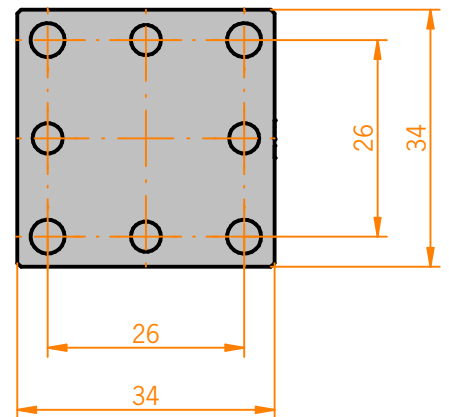
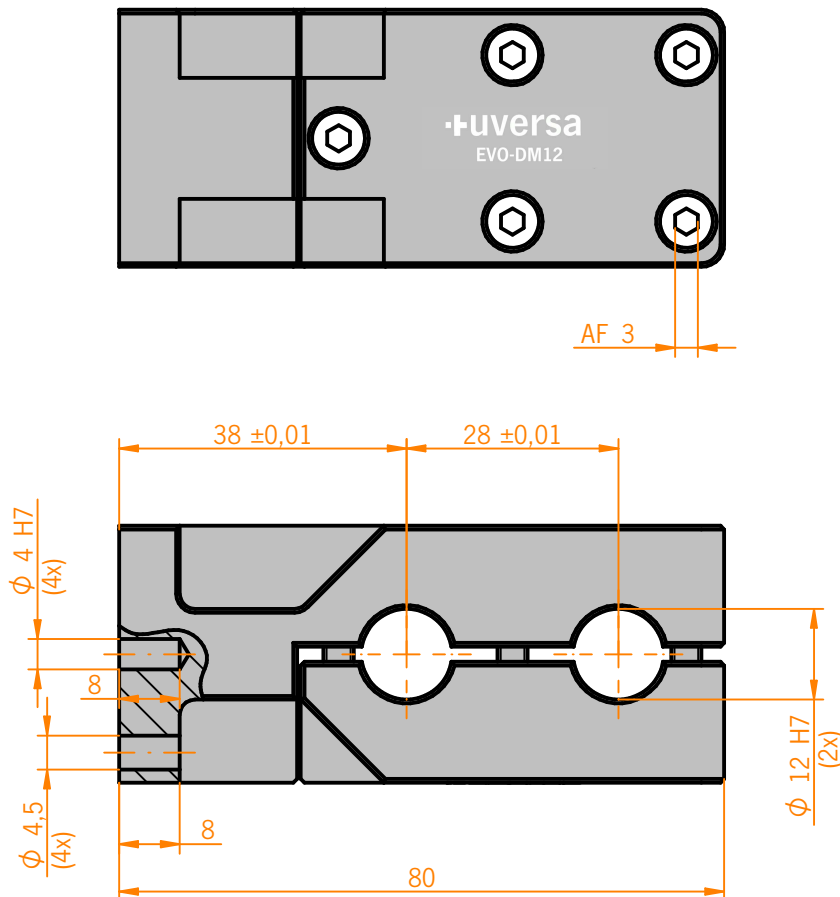

www.uversa.de