

## +EVO-DM40

### Dual-Module



#### TECHNICAL DETAILS

|                             |  |
|-----------------------------|--|
| <b>Material</b>             | Aluminium (milled)   |
| <b>Surface</b>              | <div> <div>● black,</div> <div>● red,</div> <div>● blue,</div> <div>● green</div> <div>● gold,</div> <div>● ESD</div> </div> |
| <b>Positional Tolerance</b> | $\pm 0,01 \text{ mm}$  |
| <b>Fitting Bores</b>        |  |
| <b>Positional Tolerance</b> | $\pm 0,1 \text{ mm}$   |
| <b>Bores</b>                |  |

#### MODULE DESCRIPTION

Module with fitting and mounting bores for precise attachment of components in position. The two-piece structure enables the element quickly to be mounted to a two-column system also at a later date.

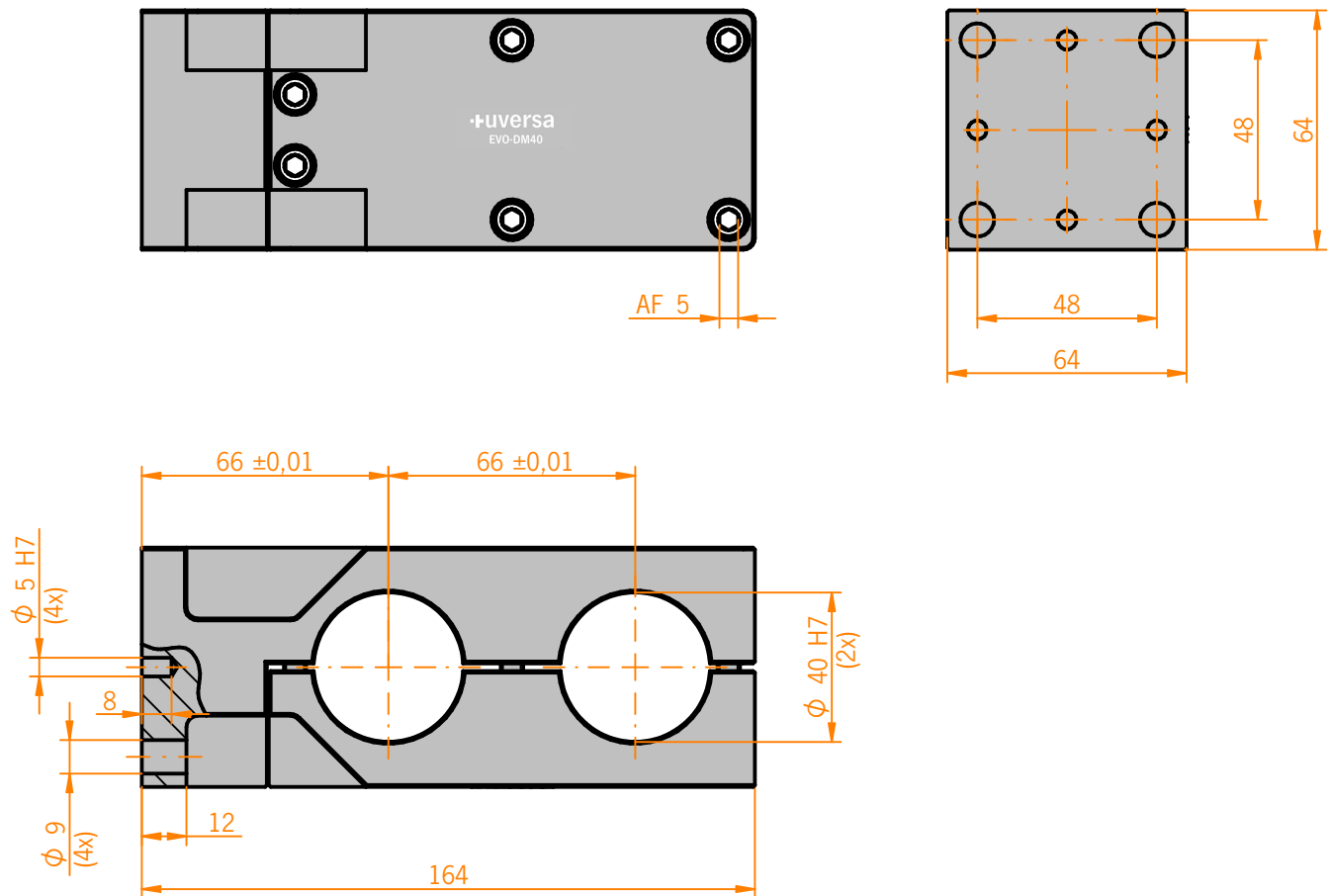

Customized items are available upon request.